

INVALCO Series 518 Valve

SSIV019 Issue/Rev. 0.5 (2/26)

The INVALCO Series 518 Valve can be used as a non-code relief valve in low pressure tanks and vessels, such as storage tanks. It is primarily designed for glycol reboiler applications.

Features and Benefits

- Positive shutoff—Reduces leakage
- Test loop—Allows for ease of testing seat

Specifications

- **Materials of Construction**
 - **Body:** Carbon Steel
 - **Plug:** 303 Stainless Steel
 - **Seat:** 303 Stainless Steel
 - **O-Ring:** Viton
- **Connections**
 - **Inlet:** 2" NPT
 - **Outlet:** 3" NPT
 - **Rain Cap:** Optional
- **Relief Pressure:** 1.3 psi
- **Reseat Pressure**
 - 1.2 psi
 - **Cv:** 38.6
 - **Cg:** 1,274
- **Temperature limits:** -20°F to 250°F



Ordering Information

Size		Model No.	Part No.
Inlet	Outlet		
2"	3"	PSG-2x3-518	80000499
2"	Rain Cap	PSG-2x3-518	80000500

NOTES:

- Part number applicable only when valve is exactly as described above.
- To order, specify model number and part number.

Installation and Operating Instructions

CAUTION: The discharge from this valve should be piped off (3" pipe), to a point where there is no possibility of burning operating personnel. There must be no valves or restrictions in the discharge line; and it must be sloped downward from the vessel.

The inner valve is provided with a looped cable to test freedom of seat. This test should not be performed during hot operation. It is recommended that the individual not place his hand in the outlet of the valve to grasp the looped cable when testing the valve. When testing the valve, engage the loop with a rod having a hook or notch in the end of the rod and stand in such a position so there is not any portion of the body in line with the outlet of the valve.

A rain cap is available for the valve, but it should not be used unless the valve is located in an area where personnel will not be endangered by hot discharges in the event the valve pops off.

Dimensions

Inches (") are to the nearest tenth (millimeters (mm) to the nearest whole mm), each independently dimensioned from respective engineering drawings.

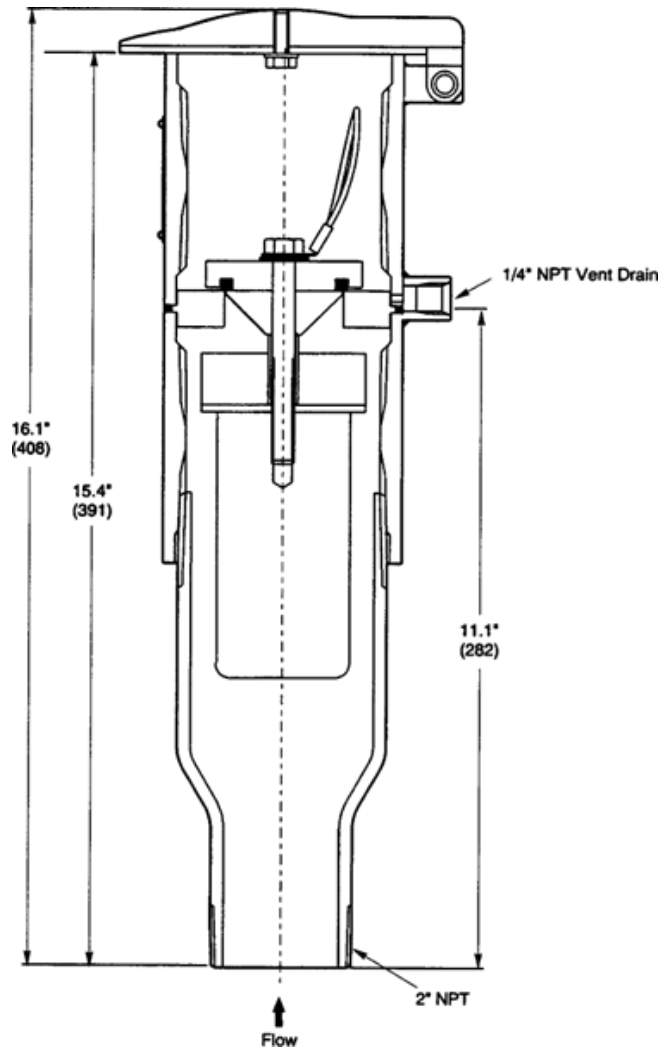

Parts

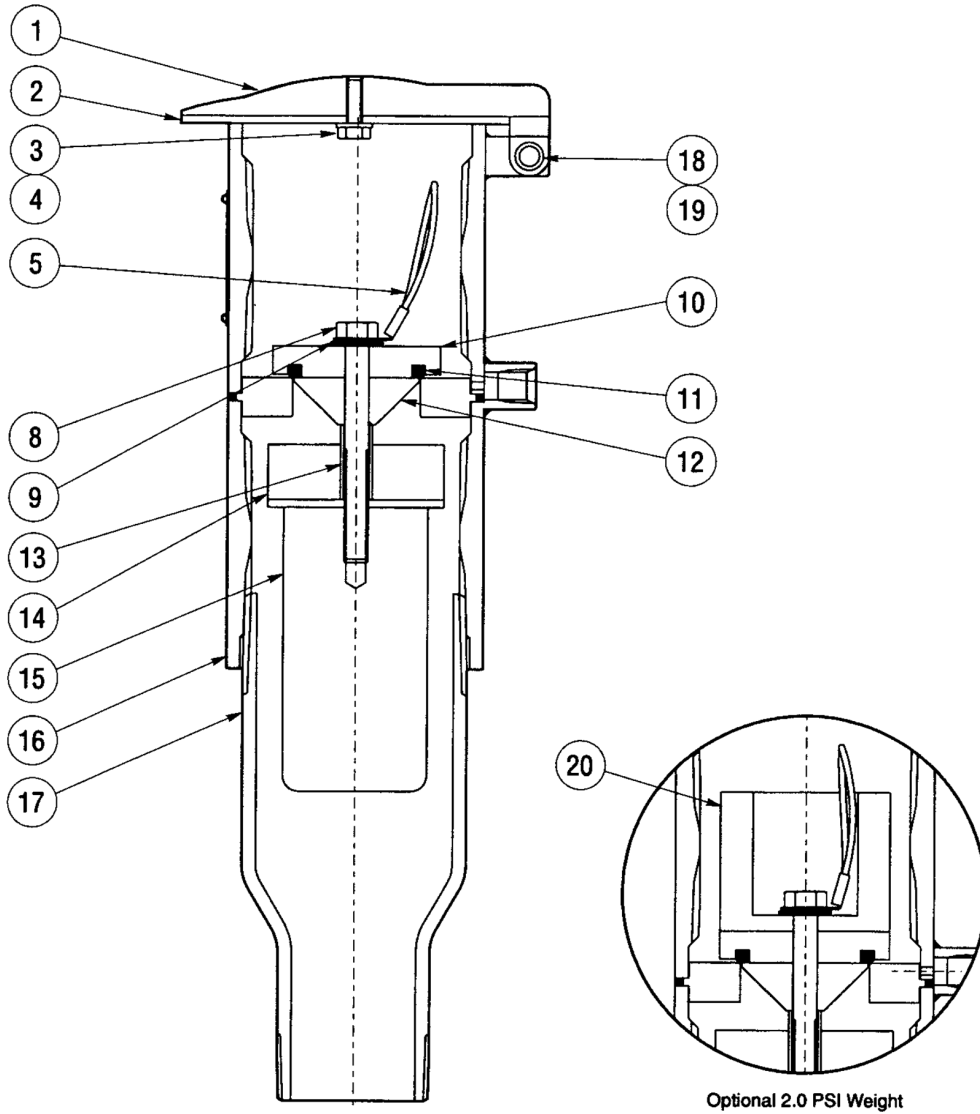

Item	Notes	Description	Qty.	Part No.
1	*	Cover	1	45005681
2	*	Gasket	1	45005703
3	*	Screw 1/4-20x3/4 HHCS	1	65011173
4	*	1/4" Flat Washer	1	65007304
5		Lifting Loop	1	48011652
8		Screw 3/8-16x3-1/2 HHCS	1	65011646
9		Seal Washer	1	45007129

Item	Notes	Description	Qty.	Part No.
10		Plug	1	45011639
11		O-Ring VIT-327-75	1	67306419
12		Cone	1	45011638
13		Spacer	1	45011637
14		Travel Stop	1	45011636
15		Weight 2-1/2 lb	1	45011635
16		Body and Seat Assembly	1	48011928
17		Swage	1	45012657
18	*	Hinge Pin	1	45001878
19	*	Cotter Pin	1	79001946
20		Weight 2 psi Relief (Optional)	1	54012252

* Optional rain cap parts.

The specifications contained herein are subject to change without notice and any user of said specifications should verify from the manufacture that the specifications are currently in effect. Otherwise, the manufacturer assumes no responsibility for the use of specifications which may have been changed and are no longer in effect.

USA
1602 Wagner Avenue
Erie, PA 16510 USA
+1 814.898.5000

Corporate Headquarters
5825 North Sam Parkway West
Suite 120
Houston, TX 77086 USA

Germany
Regentstrasse 1
25474 Ellerbek, Germany
+49 4101 304.0

GuidantMeasurement.com
© 2026 Guidant Corporation
All rights reserved.